

ĐỆM VA ĐỂ TRÒN (CELL FENDER)

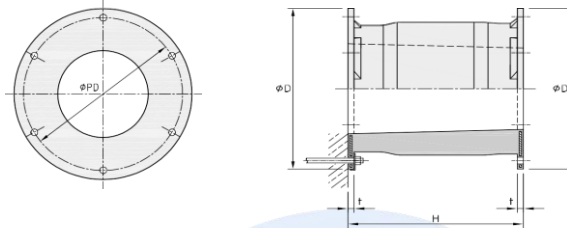

Bảng kích thước:

Fender Size	H (mm)	Ø D (mm)	t (mm)	Ø PD (mm)	Anchors / Bolts	Weight (kg)
CE 300	300	390	10	330	4 x M16	21
CE 400	400	650	25	550	4 x M24	78
CE 500	500	650	25	550	4 x M24	112
CE 600	600	780	25	660	4 x M30	185
CE 800	800	1,050	27	900	6 x M30	443
CE 1000	1,000	1,230	32	1,100	6 x M36	742
CE 1150	1,150	1,440	37	1,300	6 x M42	1,119
CE 1250	1,250	1,600	40	1,450	6 x M42	1,499
CE 1450	1,450	1,820	42	1,650	6 x M48	2,267
CE 1600	1,600	1,960	45	1,800	8 x M48	2,951
CE 1700	1,700	2,100	50	1,900	8 x M56	3,400
CE 2000	2,000	2,200	60	2,000	8 x M64	4,500
CE 2250	2,250	2,550	65	2,300	10 x M64	7,300
CE 2500	2,500	2,950	70	2,700	10 x M64	10,760
CE 3000	3,000	3,350	100	3,150	12 x M76	18,600

Office: No 3, Street 3/2, Ward 11, District 10, Ho Chi Minh City, Viet Nam

Phone: (+84) 903 180099 | 028 66589988

Email: info@catminh.com | info@catminh.net

Website: www.catminh.com | www.catminh.net | www.asiafender.com | www.demva.com | www.bichneo.com

www.yokohama-fender.vn | www.vietnamdiving.net | www.asiabollard.com | www.bulongdacbiet.com

Bảng hiệu suất:

Fender		E/R	Rubber Grades																						
Size			G 0.9	G 1.0	G 1.1	G 1.2	G 1.3	G 1.4	G 1.5	G 1.6	G 1.7	G 1.8	G 1.9	G 2.0	G 2.1	G 2.2	G 2.3	G 2.4	G 2.5	G 2.6	G 2.7	G 2.8	G 2.9	G 3.0	G 3.1
CE 300	EA	0.13	4	4	4	5	5	5	5	5	6	6	6	7	7	7	7	8	8	8	8	8	9	9	9
	RF		29	31	32	34	36	37	39	41	43	46	48	50	52	54	55	57	58	60	61	63	64	66	67
CE 400	EA	0.17	9	10	10	11	12	12	13	13	14	15	15	16	16	17	17	18	18	19	19	20	20	21	23
	RF		50	56	59	63	67	70	74	77	81	84	88	91	94	97	99	102	104	107	110	112	115	118	129
CE 500	EA	0.22	18	19	20	21	22	23	24	25	27	28	30	31	32	33	34	35	36	37	38	39	40	41	42
	RF		83	87	91	96	100	105	109	115	122	128	135	141	146	150	154	159	163	167	171	176	180	184	189
CE 600	EA	0.30	31	33	35	36	38	40	41	44	46	49	51	54	55	57	59	60	62	64	65	67	68	70	72
	RF		119	126	132	138	144	151	157	166	176	185	195	204	210	217	223	229	235	241	247	253	259	265	271
CE 800	EA	0.35	75	79	82	86	90	94	98	104	110	116	122	128	132	136	140	144	148	151	155	158	162	166	169
	RF		211	223	234	245	256	267	279	295	312	329	345	362	373	385	400	407	418	428	439	450	460	471	481
CE 1000	EA	0.44	145	153	161	168	176	184	191	203	214	226	238	249	257	264	272	280	287	295	302	309	316	324	331
	RF		331	348	366	383	401	418	435	462	488	514	540	566	583	601	618	636	653	670	686	703	719	736	752
CE 1150	EA	0.51	222	233	245	257	268	280	291	309	326	344	361	379	390	402	413	425	436	448	459	470	481	492	504
	RF		438	461	484	507	530	553	576	610	645	679	714	748	765	794	817	840	863	885	907	920	942	973	995
CE 1250	EA	0.55	284	299	314	329	343	359	374	396	419	441	464	486	501	516	531	546	561	575	590	604	618	633	647
	RF		517	544	571	598	626	653	680	720	761	802	843	884	911	938	965	993	1,02	1,045	1,071	1,096	1,122	1,15	1,173
CE 1450	EA	0.64	444	467	490	514	537	560	584	619	654	689	724	759	782	806	829	852	876	899	922	945	968	991	1,02
	RF		694	732	768	805	842	878	915	969	1,024	1,078	1,132	1,19	1,224	1,261	1,298	1,336	1,373	1,408	1,444	1,479	1,514	1,55	1,584
CE 1600	EA	0.70	596	628	659	690	721	753	785	832	879	926	973	1,02	1,051	1,083	1,114	1,145	1,177	1,206	1,236	1,265	1,295	1,32	1,353
	RF		846	891	937	982	1,027	1,073	1,118	1,185	1,251	1,318	1,385	1,45	1,495	1,538	1,58	1,624	1,667	1,71	1,753	1,797	1,84	1,88	1,926
CE 1700	EA	0.75	714	751	789	827	864	902	940	997	1,054	1,11	1,169	1,23	1,263	1,3	1,338	1,375	1,412	1,448	1,482	1,518	1,553	1,59	1,624
	RF		961	1,01	1,059	1,108	1,157	1,206	1,255	1,332	1,404	1,484	1,561	1,64	1,687	1,736	1,784	1,834	1,883	1,932	1,98	2,03	2,079	2,13	2,177
CE 2000	EA	0.88	1,165	1,23	1,287	1,348	1,408	1,469	1,53	1,622	1,714	1,806	1,898	1,99	2,052	2,112	2,173	2,234	2,295	2,354	2,413	2,471	2,53	2,59	2,648
	RF		1,322	1,39	1,463	1,534	1,604	1,675	1,746	1,86	1,953	2,057	2,161	2,27	2,334	2,403	2,471	2,54	2,609	2,675	2,742	2,809	2,875	2,94	3,009
CE 2250	EA	0.99	1,659	1,75	1,832	1,918	2,005	2,091	2,177	2,309	2,44	2,571	2,703	2,83	2,922	3,011	3,099	3,187	3,275	3,358	3,44	3,523	3,604	3,69	3,77
	RF		1,676	1,77	1,854	1,942	2,03	2,118	2,207	2,338	2,469	2,601	2,732	2,86	2,952	3,04	3,128	3,275	3,305	3,389	3,474	3,558	3,642	3,73	3,808
CE 2500	EA	1.10	2,544	2,83	2,976	3,026	3,275	3,425	3,575	3,724	3,874	4,024	4,173	4,32	4,452	4,582	4,712	4,841	4,971	5,101	5,23	5,36	5,49	5,62	6,181
	RF		2,317	2,57	2,711	2,847	2,983	3,12	3,256	3,392	3,528	3,665	3,801	3,94	4,056	4,174	4,292	4,41	4,528	4,647	4,765	4,883	5,001	5,12	5,631
CE 3000	EA	1.32	3,915	4,13	4,347	4,536	4,752	4,968	5,157	5,481	5,778	6,102	6,426	6,72	6,939	7,128	7,344	7,56	7,749	7,965	8,154	8,343	8,532	8,75	8,937
	RF		2,979	3,13	3,294	3,447	3,609	3,762	3,915	4,158	4,392	4,626	4,86	5,09	5,247	5,409	5,562	5,724	5,877	6,03	6,174	6,327	6,471	6,62	6,768

Office: No 3, Street 3/2, Ward 11, District 10, Ho Chi Minh City, Viet Nam

Phone: (+84) 903 180099 | 028 66589988

Email: info@catminh.com | info@catminh.net

Website: www.catminh.com | www.catminh.net | www.asiafender.com | www.demva.com | www.bichneo.com

www.yokohama-fender.vn | www.vietnamdiving.net | www.asiabollard.com | www.bulongdacbiet.com

Biểu đồ hiệu suất:

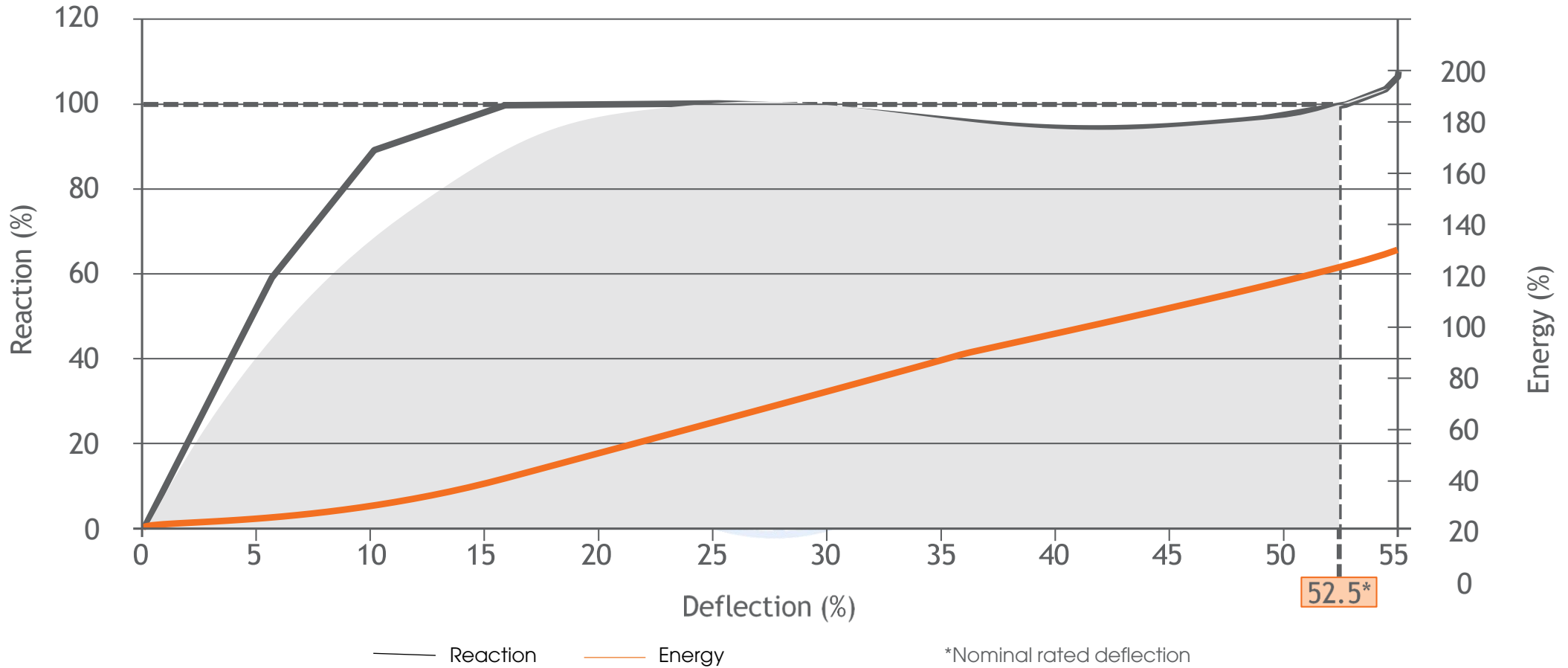

Office: No 3, Street 3/2, Ward 11, District 10, Ho Chi Minh City, Viet Nam

Phone: (+84) 903 180099 | 028 66589988

Email: info@catminh.com | info@catminh.net

Website: www.catminh.com | www.catminh.net | www.asiafender.com | www.demva.com | www.bichneo.com

www.yokohama-fender.vn | www.vietnamdiving.net | www.asiabollard.com | www.bulongdacbiet.com